

SURVEYOR'S OFFICE
Hamilton County

Kenton C. Ward, Surveyor

Phone (317) 776-8495

Fax (317) 776-9628

Suite 146

One Hamilton County Square

Noblesville, Indiana 46060-2230

TO: Hamilton County Drainage Board

May 18, 1999

RE: Thor Run Drain, Valleys @ Geist, Section 2 Arm.

Attached is a petition, non-enforcement request, plans, calculations, quantity summary and assessment roll for the Valleys @ Geist, Section 2 Arm, Thor Run Drain. I have reviewed the submittals and petition and have found each to be in proper form.

I have made a personal inspection of the land described in the petition. Upon doing so, I believe that the drain is practicable; will improve the public health; benefit a public highway and be of public utility; and that the costs, damages and expenses of the proposed drain will probably be less than the benefits accruing to the owners of land likely to be benefited. The drain will consist of the following:

6" SSD	715 ft	Open Ditch	525 ft
12" RCP	24 ft		
15" RCP	59 ft		

The total length of the drain will be 1323 feet.

The subsurface drains (SSD) to be part of the regulated drain are those located under the curbs. Only the main SSD lines which are located within the right of way are to be maintained as regulated drain. Laterals for the individual lots will not be considered part of the regulated drain.

Included as part of the drain is the open ditch running from Structure 105 to Thor Run across the Marina Limited Partnership, parcel 13-15-12-00-00-011.000 and James J. and Nancy Fuqua, parcel 13-16-07-00-00-001.000.

I have reviewed the plans and believe the drain will benefit each lot equally. Therefore, I recommend each lot be assessed equally. I also believe that no damages will

result to landowners by the construction of this drain. I recommend a maintenance assessment of \$50.00 per lot, \$5.00 per acre for roadways, with a \$50.00 minimum except for lot 17, which shall be assessed at a rate of \$25.00. With this assessment the total annual assessment for this drain/this section will be \$175.00.

Parcels assessed for this drain may also be assessed for the Valleys at Geist Drain.

I believe this proposed drain meets the requirements for Urban Drain Classification as set out in IC 36-9-27-67 to 69. Therefore, this drain shall be designated as an Urban Drain.

I recommend that upon approval of the above proposed drain that the Board also approve the attached non-enforcement request. This request is for the reduction of the regulated drain easement to those easement widths as shown on the secondary plat for Valleys at Geist, Section 2 as recorded in the office of the Hamilton County Recorded. Easements for the open ditch serving as the offsite system across Fuqua and Marina shall be 30 feet on both sides of the ditch's centerline as measured at right angles.

I recommend the Board set a hearing for this proposed drain for June 28, 1999.

Sincerely,

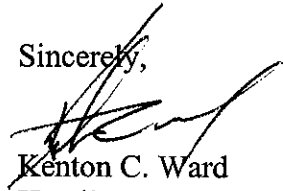

Kenton C. Ward
Hamilton County Surveyor

KCW/kkw



SURVEYOR'S OFFICE Hamilton County

Kenton C. Ward, CFM
Surveyor of Hamilton County
Phone (317) 776-8495
Fax (317) 776-9628

Suite 188
One Hamilton County Square
Noblesville, Indiana 46060-2230

To: Hamilton County Drainage Board

January 15, 2010

Re: Thor Run: Valley's at Geist Section 2

Attached are as-builts, certificate of completion & compliance, and other information for Valley's at Geist Section 2. An inspection of the drainage facilities for this section has been made and the facilities were found to be complete and acceptable.

During construction, changes were made to the drain, which will alter the plans submitted with my report for this drain-dated May 18, 1999. The report was approved by the Board at the hearing held June 28, 1999. (See Drainage Board Minutes Book 5, Pages 165-166)
The changes are as follows:

Structure:	Length:	Size:	Material:	Up Invert:	Dn Invert:	Grade:
106-105	31	15	RCP	836.92	836.58	1.1
107-106	28	15	RCP	837.14	836.92	0.8
108-107	24	12	RCP	837.75	837.39	1.5
RCP Pipe Totals:			SSD Totals:			
12	24		Streets	593		
15	59		Other Drain:			
Total:	83		Open Ditch	505		
			Total:	1098		

The length of the drain due to the changes described above is now **1181 feet**.

The non-enforcement was approved by the Board at its meeting on June 28, 1999 and recorded under instrument # 1999052019.

The following sureties were guaranteed by Fidelity and Guaranty Insurance Co. and will be released by the Board on its January 26, 2010 meeting.

Bond-LC No: 31012019835994
Insured For: Storm Sewers
Amount: \$60,094.40
Issue Date: March 25, 1999

I recommend the Board approve the drain's construction as complete and acceptable.

Sincerely,

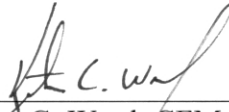
A handwritten signature in black ink, appearing to read "K.C. Ward", written over a horizontal line.

Kenton C. Ward, CFM
Hamilton County Surveyor

KCW/slm

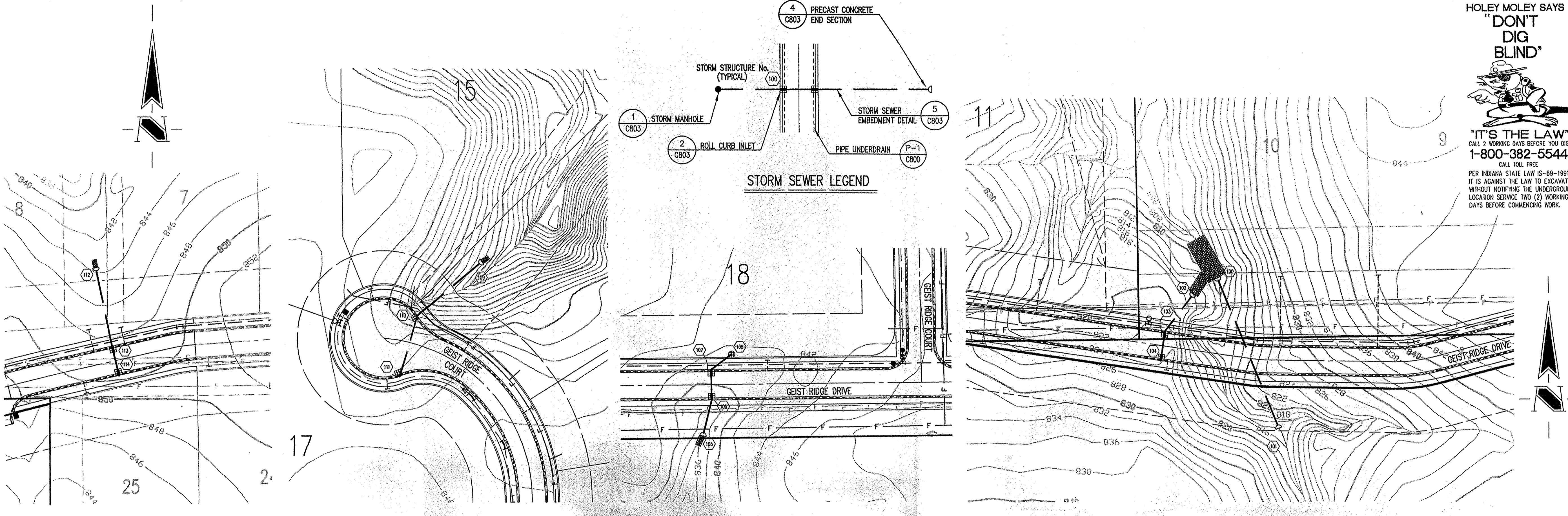

HOLEY MOLEY SAYS
"DON'T DIG BLIND"

"IT'S THE LAW"
 CALL 2 WORKING DAYS BEFORE YOU DIG
1-800-382-5544
 CALL TOLL FREE
 PER INDIANA STATE LAW IS-69-1891,
 IT IS AGAINST THE LAW TO EXCAVATE
 WITHOUT NOTIFYING THE UNDERGROUND
 LOCATION SERVICE TWO (2) WORKING
 DAYS BEFORE COMMENCING WORK.

GENERAL NOTES

- ALL CUTS ARE TAKEN FROM THE EXISTING GRADE TO THE PIPE INVERT.
- ALL STATIONING IS TAKEN FROM THE NEAREST DOWNSTREAM STRUCTURE.
- IT SHALL BE THE CONTRACTORS RESPONSIBILITY TO FIELD VERIFY ALL UTILITY LOCATIONS BEFORE CONSTRUCTION BEGINS.
- TEMPORARY TRAFFIC CONTROL DURING CONSTRUCTION TO CONFORM TO APPLICABLE O.S.H.A. LOCAL AND STATE STANDARDS.
- ALL CONSTRUCTION ACTIVITY ON THIS SITE TO BE PERFORMED IN COMPLIANCE WITH APPLICABLE O.S.H.A. STANDARDS FOR WORKER SAFETY.
- CONTRACTOR SHALL MINIMIZE DAMAGE TO EXISTING TREES.
- IF ANY EXISTING FIELD TILE ARE ENCOUNTERED DURING THE CONSTRUCTION PROCESS, THE CONTRACTOR SHALL BE RESPONSIBLE FOR RECONSTRUCTING THE TILE TO ITS ORIGINAL CONDITION OR CONNECTING IT INTO THE PROPOSED STORM DRAINAGE SYSTEM.
- CONTRACTOR HAS THE OPTION OF PIPE MATERIAL USED FOR STORM SEWERS AS SPECIFIED ON SHEET C903. THE CONTRACTOR SHALL NOTE WHICH PIPE MATERIAL CHOSEN IN BID FORMS.
- ALL STORM SEWER MANHOLES AND INLET SHALL BE CONSTRUCTED OF PRECAST CONCRETE.

BENCHMARK

HSE DISC IN CONCRETE AT WEST BOUNDARY OF THE INTRACOASTAL SET SEVENTY (70) FEET +/- SOUTH OF 113th STREET, 1/4 MILE WEST OF FLORIDA ROAD.
 ELEV.=808.39

Revisions
 1. DEC 3/10/99; HAMILTON CO. HIGHWAY AND SURVEYORS COMMENTS.

STORM SEWER PLAN

SCALE: 1"=50'

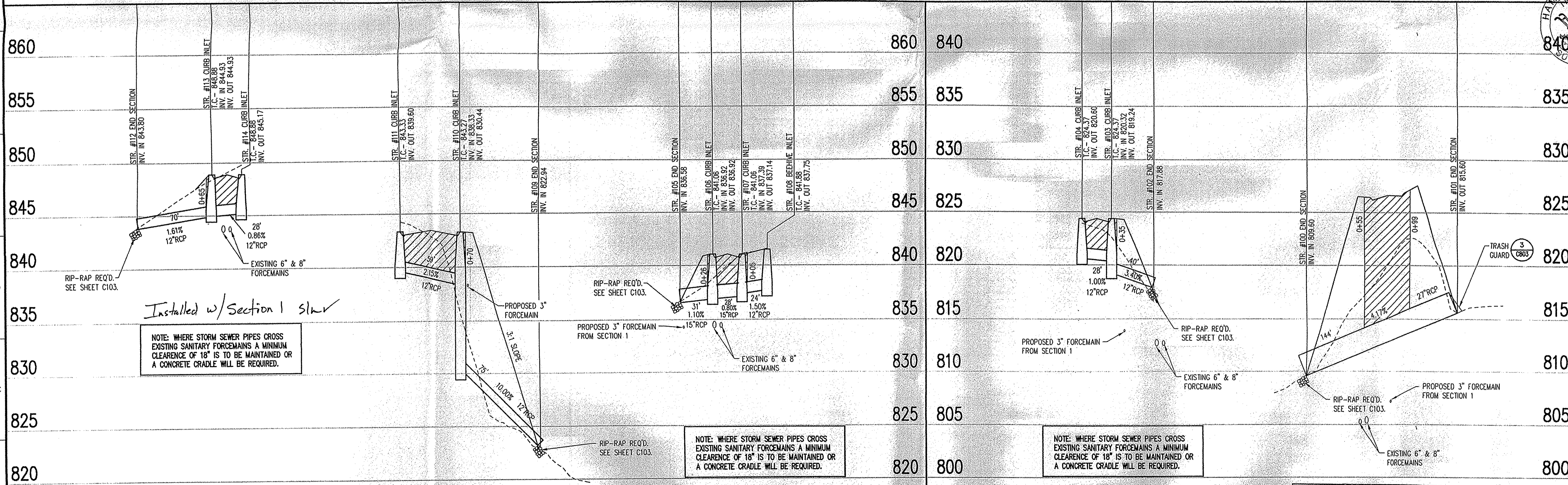

HAMILTON COUNTY SURVEYORS OFFICE
APPROVED
 BY: *John C. Wolf*
 DATE: MAY 25 1999

Approved where drainage plans comply with Hamilton County Regulated Drain Design Standards only and does not imply Drainage Board acceptance nor secondary plat approval.

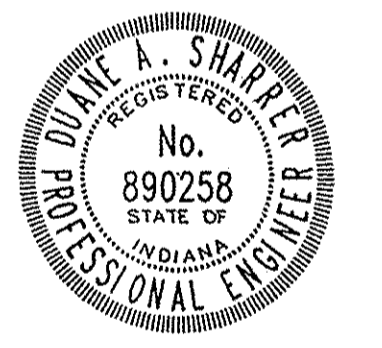

CERTIFIED BY: _____
 THIS DRAWING AND THE IDEAS, DESIGNS AND CONCEPTS CONTAINED HEREIN ARE THE EXCLUSIVE INTELLECTUAL PROPERTY OF THE SCHNEIDER CORPORATION AND ARE NOT TO BE USED OR REPRODUCED IN WHOLE OR IN PART, WITHOUT THE WRITTEN CONSENT OF THE SCHNEIDER CORPORATION.
 1999, The Schneider Corporation

The Schneider Corporation
 3020 North Post Road
 Indianapolis, Indiana 46228-6518
 317-898-8282
 317-899-8010 Fax
 Engineering
 Surveying
 Landscape Architecture
 GIS • LIS
 Geology

FILED
 APR 07 1999
 HAMILTON COUNTY SURVEYOR
 Form 10-1998
 THE VALLEYS AT GEIST SECTION TWO
 HAMILTON COUNTY, INDIANA

STORM SEWER PLAN & PROFILE

Date	Project No.	Drawn	Apprv.
1/21/99	2188.002	DTR	

Computer Files
 J:\2K\2188\002\DWG\C601
 XREF: J:\2K\2188\002\DWG\C903
 XREF: J:\2K\2188\001\DWG\SUBS
 XREF: J:\2K\2188\002\DWG\STORM2
 XREF: J:\2K\2188\001\DWG\SS-BS

Sheet No.
C601

STORM SEWER PROFILE

LEGEND

Existing Grade	New Grade	Granular Backfill

SCALE: HORIZ.: 1"=50'
 VERT.: 1"=5'